







MONOLITH Atmospheric Water Generator | Instruction Manual | Model: AWG-W-2GPD

## Thank You for Choosing Spout!

We're thrilled that you've chosen Spout.® With every sip you're enjoying fresh, pure water created from the air around you—inspired by nature! In this Instruction Manual, you'll find everything needed to get set up and start enjoying high-quality water. Thank you again for joining us on this sustainable path to a purer, healthier, and greener tomorrow.

	Read and review instructions for operation and use.
	Indicates the presence of a hazard that can cause personal injury, death or substantial property damage if the warning included with this symbol is ignored.
	<b>WARNING:</b> This product may expose you to chemicals which are known to the State of California to cause cancer and birth defects or other reproductive harm. For more information got to <a href="http://www.P65Warnings.ca.gov">www.P65Warnings.ca.gov</a>
	For indoor and household use only.
	When using electrical appliances, basic safety precautions should always be followed, including the following:

### **WARNING**

To reduce the risk of injury, fire, electrical shock or property damage, basic safety precautions must always be followed, including the following numbered warnings and subsequent instructions. Do not use appliance for other than intended use.

1. Read all instructions prior to using the appliance and its accessories.
2. Carefully observe and follow all warnings and instructions. This appliance contains electrical connections and moving parts that presents potential risk to the user.
3. Take inventory of all contents to ensure you have all parts needed to properly and safely operate your appliance.
4. Turn the appliance **OFF**, remove the pitcher, then unplug the appliance from the outlet before moving appliance. To unplug, grasp the plug by the body and pull from the outlet. **NEVER** unplug by grasping and pulling the power cord.
5. Before use, hand wash all parts that may contact drinking water. Follow washing instructions covered in the BEFORE FIRST USE section.

## ⚠ WARNING

To reduce the risk of injury, fire, electrical shock or property damage, basic safety precautions must always be followed, including the following numbered warnings and subsequent instructions. Do not use appliance for other than intended use.

- DO NOT OPERATE THE APPLIANCE WITHOUT THE AIR OR WATER FILTER INSTALLED. FAILURE TO DO SO WILL RESULT IN PERMANENT DAMAGE TO THE APPLIANCE.**
- DO NOT** put the pitcher in a freezer with or without water inside of it.
- IMPORTANT:** Air and water filters must be replaced every three ( 3 ) months to ensure optimal performance and water quality.
- DO NOT** consume water after three ( 3 ) months of having a filter installed. **DO NOT** consume water without the air filter installed.
- DO NOT** block the air intake or exhaust.
- DO NOT** use this device in the presence of any substances or devices that release airborne particles, vapors, or aerosols. This includes, but is not limited to, air fresheners, incense, perfumes, essential oils, oil diffusers, aerosol sprays, or similar products. Such substances can interfere with the proper functioning or safety of the device and may compromise the quality of the water it produces.
- DO NOT** use this appliance outdoors. It is designed for indoor, household use only.
- DO NOT** operate any appliance with a damaged cord or plug, or after the appliance malfunctions or is dropped or damaged in any manner. This appliance has no user serviceable parts. If damaged, contact [support@spoutwater.com](mailto:support@spoutwater.com) for servicing.
- Extension cords must **NOT** be used with this appliance.
- To protect against the risk of electric shock, **DO NOT** submerge the appliance or allow the power cord to contact any form of liquid.
- DO NOT** allow the cord to hang over the edges of tables or counters. The cord may become snagged and pull the appliance off the surface. **DO NOT** allow the cord or appliance to contact hot surfaces, such as stoves and other heating appliances.
- ALWAYS** use the appliance on a dry and level surface.
- DO NOT** allow children to operate this appliance or use as a toy.
- ONLY** use attachments and accessories that are provided with the product or are recommended by **SPOUT**. The use of attachments not recommended or sold by **SPOUT** may cause fire, electric shock, or injury.
- DO NOT** attempt to defeat the interlock mechanism. Ensure the pitcher and lid are properly installed before operation.

## THE PARTS OF YOUR SPOUT APPLIANCE

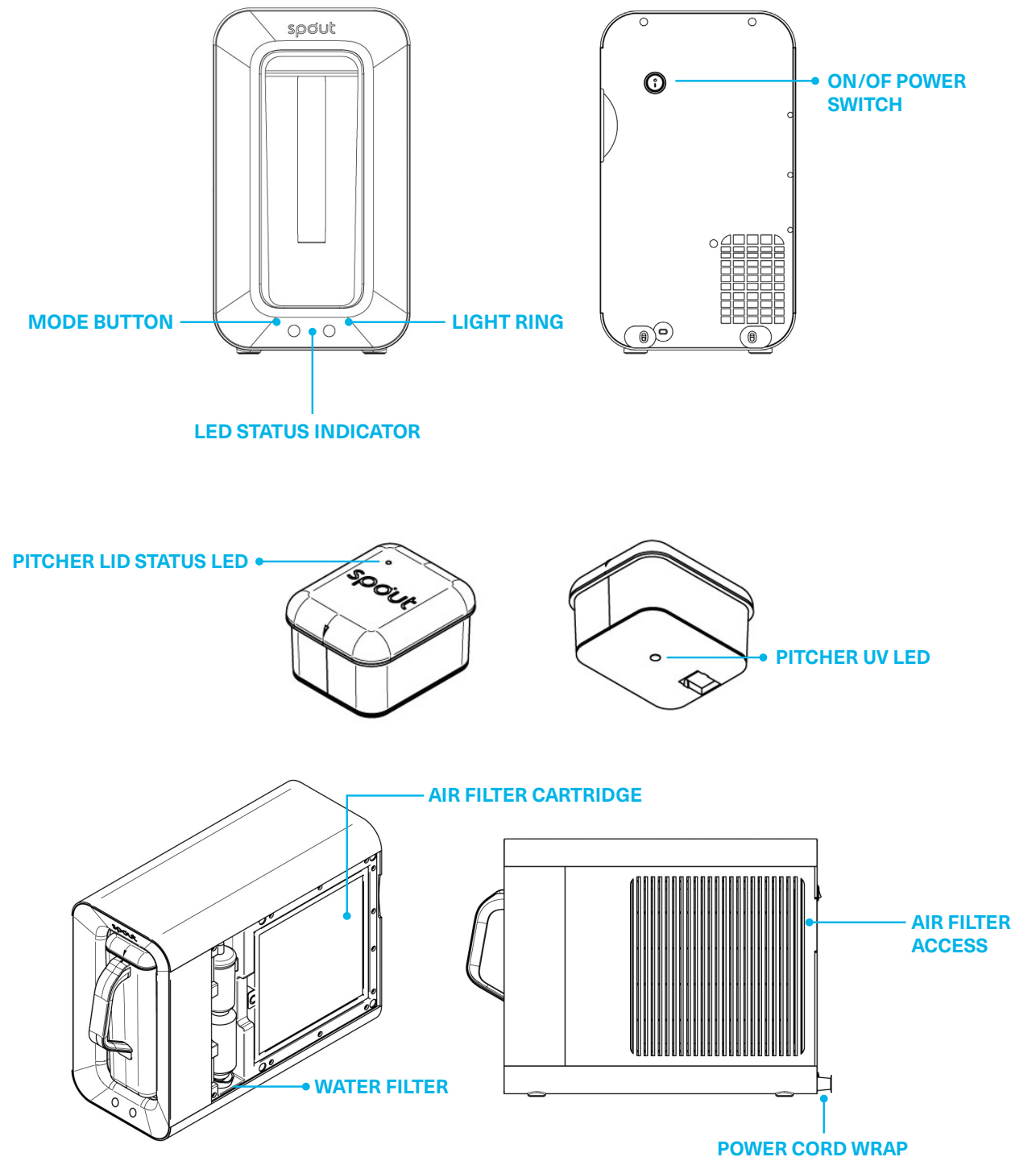

## BEFORE FIRST USE

**IMPORTANT:** Review all warnings before proceeding.

**NOTE:** All materials contained within the water production system are BPA free. The appliance, pitcher, and lid are **HAND WASH ONLY** with mild detergents. **NEVER** submerge the lid in water.

1. Remove the Spout Monolith from packaging base using the convenient bag handles.
2. Remove pitcher from the bag.
3. Remove the Spout Monolith from the carrying bag. Be sure to keep all your packaging materials and carry bag.
4. Wash pitcher and lid with warm, soapy water. **NEVER** submerge the lid in water. **NEVER** put hot or boiling water in the pitcher
5. Wipe appliance with a soft cloth.
6. Open access panel and ensure that the water filter fitting is fully seated on the bottom, as items can shift in transit.
7. **IMPORTANT:** The first four ( 4 ) pitchers of water are to be discarded in order to purge the water filter. This action is to be done on the first use out of the box and whenever a new water filter is installed into the appliance.

**NOTE:** The pitcher lid has a battery and UV-C light to keep your water fresh for up to 24hrs in the refrigerator or counter-top.

## FEATURES









- Made from food-grade materials
- Advanced water filter technology and ultraviolet light to kill bacteria and viruses
- Microcomputer control technology for automatic operation
- Energy-saving features like automatic shutoff when the tank is full
- Anti-tip sensor for added safety (**NEVER** move your water generator while the power is on)
- Water leakage detector
- Novel and noble body design
- Two water production levels
- Adjustable LED light ring
- Customer replaceable water and air filters
- MERV 10 air filtration







## USING YOUR SPOUT APPLIANCE



### INSTALLATION GUIDE

1. Place the appliance on a firm, horizontal surface.
2. Allow a minimum of 6 inches (150mm) on either side of the appliance to allow for proper air flow.
3. Plug into a grounded power outlet.
4. Insert and fully seat the Pitcher Lid into pitcher, alignment arrows located on the lid and pitcher handle.
5. Insert Pitcher with Lid into appliance.
6. Turn power switch, located on the rear of the appliance, to the on position.

### OPERATION AND DISPLAY

LED STATUS INDICATOR & MODE BUTTON		
 WHITE	BLINKING	Appliance ready, no pitcher present
 WHITE	SOLID	Appliance ready; Standby Mode NOTE: THIS MODE IS TO BE USED WHEN Appliance IS NOT IN USE
 BLUE	SOLID	High Fan Speed, High Heat Use this mode for highest water production.
 GREEN	SOLID	High Fan Speed, Low Heat Use this mode for low energy usage.
 RED	BLINKING	Over temperature sensor activated. See Trouble Shooting Guide section.
 BLUE	BLINKING	Leak sensor activated. See Trouble Shooting Guide section.
 GREEN	BLINKING	Anti-tip sensor activated. See Trouble Shooting Guide section.
 PURPLE	BLINKING	Pump error. See Trouble Shooting Guide section.

PITCHER LID		
 WHITE	BLINKING	Normal Operation
 GREEN	BLINKING	Charging
 GREEN	SOLID	Fully Charged
 BLUE	BLINKING	Charging /Pitcher Full
 BLUE	SOLID	Pitcher Full
 RED	BLINKING	Battery Low
IF THE PITCHER LID ILLUMINATES ANY OTHER COLOR, PLEASE CONTACT SUPPORT@SPOUT.COM		

LIGHT RING		
 BLUE	SOLID	Pitcher is full
 ORANGE	SOLID	Change filter three (3) month indicator
 RED	SOLID	Turn off and replace filter immediately. See Troubleshooting on how to reset.

## FILTER REPLACEMENT

**IMPORTANT:** The first four ( 4 ) pitchers of water are to be discarded in order to purge the water filter. This action is to be done on the first use out of the box and whenever a new water filter is installed into the appliance.

**Replace filter every 3 months.** ① When the filters need to be replaced, remove the right side panel. Using the depression located at the back of the appliance, pull away to gain access to both filters. **NOTE:** The side panel hinges towards the front and can be fully removed. Be sure to replace before using the appliance.

**Air Filter Replacement:** ② Using the **SPOUT** logo as a handle, pull the filter cartridge out of the appliance and replace it with a new filter pack. Be sure that the black carbon filter is facing outwards, and the pleated filter is facing towards the inside of the appliance.

**Water Filters Replacement:** ③ To replace the water filter, grab the top of the filter and rotate down. This will remove the fill tube from inside of the appliance. Once the fill tube is fully visible, gently pull up on the filter body until it stops, allowing access to the water fitting at the bottom of the filter. Slide the quick disconnect tool upwards, towards the filter body which will disengage the locking ring. At the same time gently pull down on the fitting to remove it from the filter body. The water filter will then be free of inlet water tube. Remove the water filter and dispose of it.

**NOTE:** The water filter will have water inside and it is normal for some water to drip from the bottom of the old filter.

**IMPORTANT: WHEN CHANGING THE WATER FILTER, AVOID ALLOWING WATER TO ENTER INTO THE HOUSING OF THE ATMOSPHERIC WATER GENERATOR. IT IS POSSIBLE TO ACTIVATE THE LEAK DETECTOR.**

When changing the air filter; it is common to see dirt and grim on the inside of the side panel. These are contaminants in the air that the Spout Monolith is scrubbing from your home. Wipe panel with a soft cloth or warm, soapy water as needed.

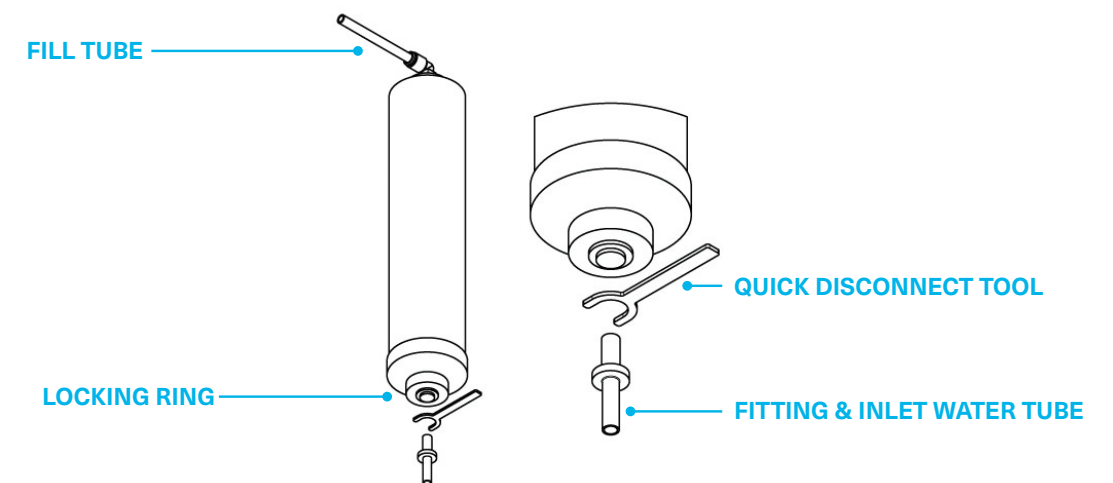
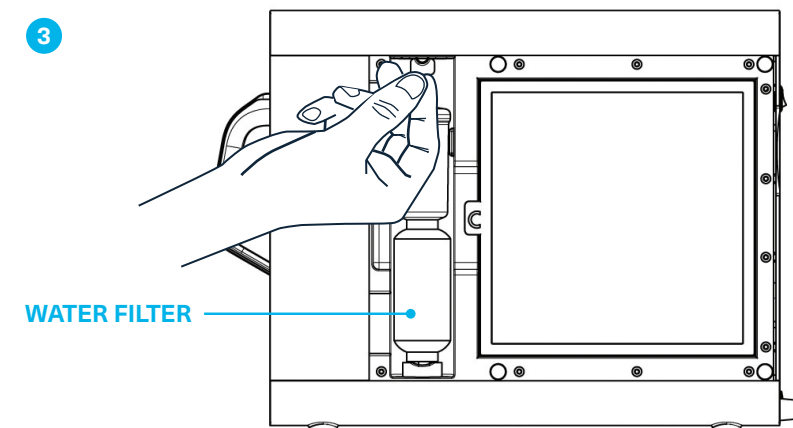
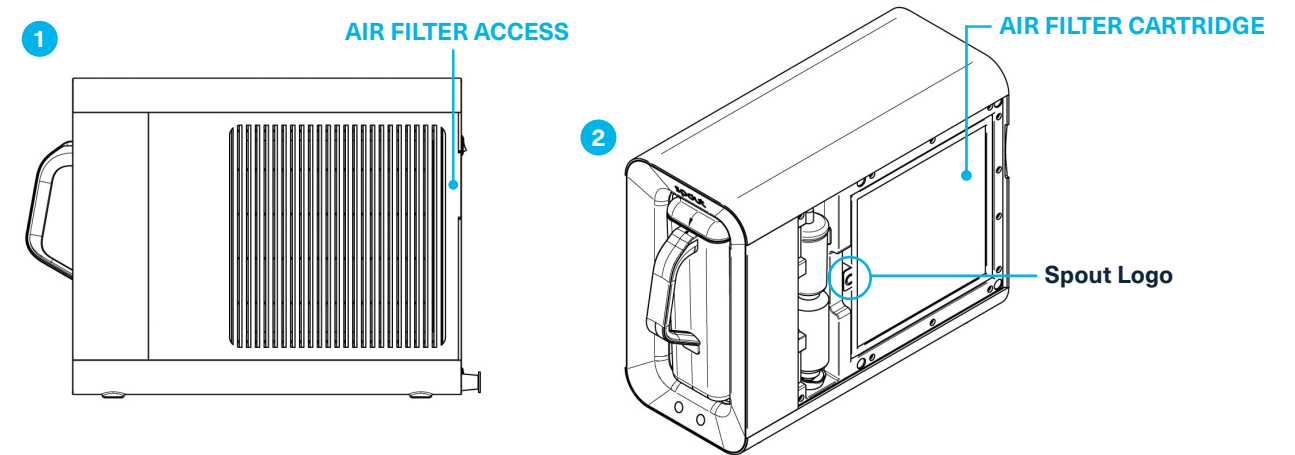

## ⚠ WARNING

To reduce the risk of electrical shock and unintended operation, turn power off and unplug appliance before troubleshooting.

## TROUBLESHOOTING GUIDE

ISSUE	PROBLEM	SOLUTION
Orange Light Ring	Time to replace air and water filters	Replace air and water filters per instructions and PRESS and HOLD light ring button for > 5 seconds
Not Making Water	Anti-tip sensor activated (Green, blinking LED)	Turn off power on the back of the appliance and unplug. Wait 2 minutes and then plug back into wall socket and turn appliance on.
	Leak sensor activated (Blue, blinking LED)	Turn off power on the back of the appliance and unplug. Wait 24hrs and then plug back into wall socket and turn appliance on. Check that the water filter is fully inserted. See the previous page for correct insertion.
	Over temperature sensor activated (Red, blinking LED)	Turn off power on the back of the appliance and unplug. Ensure that the back and sides of the appliance are not obstructed. Wait 1hr and then plug back into wall socket and turn appliance on.
	Humidity too low	Open a window to allow fresh air into room or try moving appliance to a different location.
	Filter clogged	Replace air and water filter every three ( 3 ) months.
	Inlet water line kinked	Remove water filter and inspect inlet water line (bottom of filter). Gently feed excess water line into appliance cavity. DO NOT completely push the water line and connector into the appliance cavity.
	Pump time-out error (Purple, blinking LED)	Pump ran for too long. Turn off power on the back of the appliance, unplug appliance. Wait 2 minutes and then plug back into wall socket and turn appliance on.
Not Making A Lot of Water	Anti-tip sensor activated (Green, blinking LED)	Turn off power on the back of the appliance and unplug. Wait 2 minutes and then plug back into wall socket and turn appliance on.
	Filter clogged	Replace air and water filter every three ( 3 ) months.
	Inlet water line kinked	Remove water filter and inspect inlet water line (bottom of filter). Gently feed excess water line into appliance cavity. DO NOT completely push the water line and connector into the appliance cavity. Open a window/door or put in a larger or more humid room.

## ⚠ WARNING

To reduce the risk of electrical shock and unintended operation, turn power off and unplug appliance before troubleshooting.

## TROUBLESHOOTING GUIDE (cont.)

ISSUE	PROBLEM	SOLUTION
Loud Noise	Exhaust fan	Did you know that your atmospheric water generator is also an air filter? In order to draw humidity into the appliance to make water, there is a high-speed fan pulling air into the appliance and extracting water from the air.
	Pump	Once the condensate water tray is full of water, the pump draws the water and pushes it through the multi-stage water filter.
Light Ring Not Working	Light ring is turned off	Press light ring button to turn on.
Pitcher Lid UV Not Working	Lid not installed in pitcher correctly	The pitcher lid has a safety feature, the UV lamp will only work when the lid is properly installed.  The pitcher lid battery may need to be charged. Replace pitcher, with lid, into the appliance and charge till full.

FOR ALL OTHER ISSUES while in use under normal household conditions within the warranty period, visit [support@spoutwater.com](mailto:support@spoutwater.com) for product care and maintenance self-help.

## ORDERING REPLACEMENT PARTS

To order additional parts and attachments, visit [SPOUTWATER.COM](https://spoutwater.com)

## PRODUCT REGISTRATION

Register your product within thirty (30) days of purchase using the enclosed registration card. The registration will enable us to contact you in the unlikely event of a product safety notification. By registering, you acknowledge you have read and understood the instructions for use and warnings set forth in the accompanying instructions.

### ONE (1) YEAR LIMITED WARRANTY

The One (1) Year Limited Warranty applies to purchases made from authorized retailers of **SPOUT VENTURES LLC**. Warranty coverage applies to the original owner and to the original product only and is not transferable.

SPOUT warrants that the appliance shall be free from defects in material and workmanship for a period of one (1) year from the date of purchase when it is used under normal household conditions and maintained according to the requirements outlined in the Owner's Guide, subject to the following conditions and exclusions:

#### What is covered by this warranty?

1. The original appliance and/or non-wearable parts deemed defective, in SPOUT sole discretion, will be repaired or replaced up to one (1) year from the original purchase date.
2. In the event a replacement appliance is issued, the warranty coverage ends six (6) months following the receipt date of the replacement appliance or the remainder of the existing warranty, whichever is later. SPOUT reserves the right to replace the appliance with one of equal or greater value.

#### What is not covered by this warranty?

1. Normal wear and tear of wearable parts (such as pitcher, lids, access panels), which require regular maintenance and/or replacement to ensure the proper functioning of your appliance, are not covered by this warranty. Replacement parts are available for purchase at [SPOUTWATER.COM](https://spoutwater.com)

2. Any appliance that has been tampered with or used for commercial purposes.
3. Damage caused by misuse, abuse, negligent handling, failure to perform required maintenance (e.g., failure to keep the well of the motor base clear of food spills and other debris), or damage due to mishandling in transit.
4. Consequential and incidental damages.
5. Defects caused by repair persons not authorized by SPOUT. These defects include damages caused in the process of shipping, altering, or repairing the SPOUT product (or any of its parts) when the repair is performed by a repair person not authorized by SPOUT.
6. Products purchased, used, or operated outside North America.

#### How to get service

If your appliance fails to operate properly while in use under normal household conditions within the warranty period, visit [SPOUTWATER.COM](https://spoutwater.com) for product care and maintenance self-help. Our Customer Service Specialists will assist with product support and warranty service options. So we may better assist you, please register your product and have the product on hand when you call.

#### How to initiate a warranty claim

You will need the receipt as proof of purchase. We also ask that you register your product and have the product on hand, so we may better assist you. A Customer Service Specialist will provide you with return and packing instruction information.

#### How state law applies

This warranty gives you specific legal rights, and you also may have other rights that vary from state to state. Some states do not permit the exclusion or limitation of incidental or consequential damages, so the above may not apply to you.

## RECORD THIS INFORMATION

Serial Number:

Date of Purchase: *(Keep receipt)*

Store of Purchase:



## TECHNICAL SPECIFICATIONS

Voltage: 120V~, 60Hz

Power: 700 Watts

### **SPOUT VENTURES LLC**

10871 Washington Blvd. #103

Culver City, CA 90232

**spoutwater.com**

Illustrations may differ from actual product.  
We are constantly striving to improve our products,  
therefore the specifications contained herein are  
subject to change without notice.

This product may be covered by one or more U.S. patents.  
See **spoutwater.com** for more information.